

I PROY
I PRN20W
20W LED Projector



HIGH EFFICIENCY
100 lm/W



GARANTÍA



HIGH QUALITY

SPECIFICATIONS · PRODUCT DATA

Electrical data	
Input	220 ~ 240 Vac
Mains frequency	50/60Hz
Power	20W
Power factor	>0.9
LEDs n°	24 chips SMD2835
LED power	0.83W
IEC protection class	Class I
Photometric data	
Luminous efficiency	100lm/W
CRI (Ra)	>80
Luminous lux (Nominal / Real) CCT	2600lm · 2000lm · 6500K · BF 2600lm · 2000lm · 4000K · BN 2600lm · 2000lm · 3000K · BC
Luminous intensity	611 cd
SDCM Standard deviation colour adjustment	<3
Degree of opening	120°
Working Temp.	-20°C +45°C
Switchovers n°	30.000
Certifications	CE, RoHS
Energy efficiency	A+
Working life	30.000h (L80:B10)
Materials and physical characteristics	
Body	Aluminum casting
Diffuser	Tempered glass
Reflector	Aluminum
Bracket	Aluminum casting
Finish	Black RAL 7015 White* RAL 9016
Measurements in mm (length x width x height)	161 X 33.5 X 156
Weight (g)	523
Characteristics	
IP Rating	IP65
IK Rating	IK08
UGR Rating	<22
Options	
Dimming option	No
Emergency kit option	No
Sensor movement option	Yes (SP65)
Packaging	
Packaging measurements	515 X 270 X 167
Packaging weight (kg)	10.1
Units (units/box)	18 units

*White finish available in Neutral White

Measurements in mm

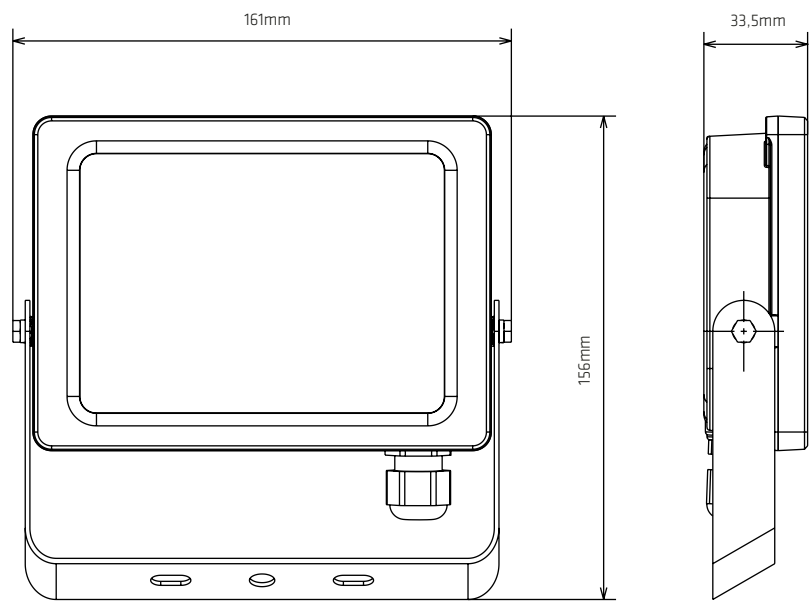



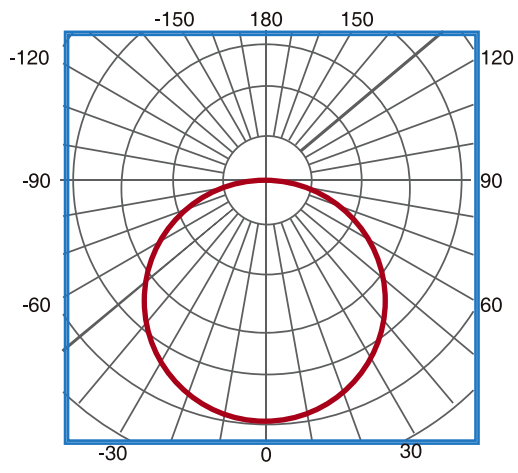

Optics

Beam angle 120°

H (m)	Diameter (m)	E _{max} (lx)
1	3.02	614.01
2	6.05	153.51
3	9.08	68.23
4	12.11	38.38



References

		W				CCT	CRI
IPRN20WBFNE	RAL7015	20 W	2600 lm	2000 lm	120°	BF: 6500K	> 80
IPRN20WBNNE	RAL7015	20 W	2600 lm	2000 lm	120°	BN: 4000K	> 80
IPRN20WBCNE	RAL7015	20 W	2600 lm	2000 lm	120°	BC: 3000K	> 80
IPRN20WBNBL	RAL9016	20 W	2600 lm	2000 lm	120°	BN: 4000K	> 80

Installation

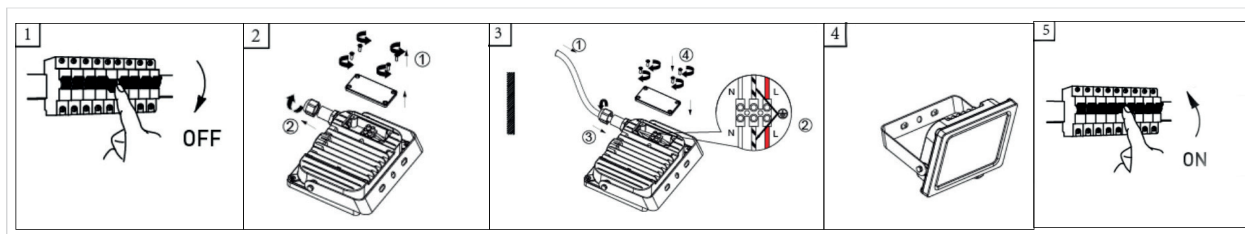

IP65

